

# Technical data sheet

## Product features



### Pot and pan washer double skin 70x70 - 400 V

<b>Model</b>	<b>SAP Code</b>	00011972
--------------	-----------------	----------



- Display type: LCD multifunction display
- Number of programs: 8
- Number of skin: 2
- Door clear height [mm]: 850
- Rack size [mm]: 700 x 700
- Water consumption of the washing cycle: 4
- Washing cycle time [s]: 120-240-360-720 sec.
- Detergent and rinse pump system: ProDose - accurate dosing with a peristaltic pump
- Wash pump type: two-way - DuoFlow
- Self-cleaning cycle: Yes
- Drain filter: ArchiMedes - double filtration with overflow discharge ensures only 18% loss of clean water to waste

<b>SAP Code</b>	00011972	<b>Boiler power [kW]</b>	8.000
<b>Net Width [mm]</b>	857	<b>Basin volume [l]</b>	68
<b>Net Depth [mm]</b>	853	<b>Tank power [kW]</b>	8.000
<b>Net Height [mm]</b>	1959	<b>Water consumption of the washing cycle</b>	4
<b>Net Weight [kg]</b>	181.00	<b>Washing cycle time [s]</b>	120-240-360-720 sec.
<b>Power electric [kW]</b>	18.700	<b>Door clear height [mm]</b>	850
<b>Loading</b>	400 V / 3N - 50 Hz	<b>Rack size [mm]</b>	700 x 700
<b>Boiler capacity [ l ]</b>	12.00		

# Technical data sheet

Technical drawing



Pot and pan washer double skin 70x70 - 400 V

Model

SAP Code

00011972

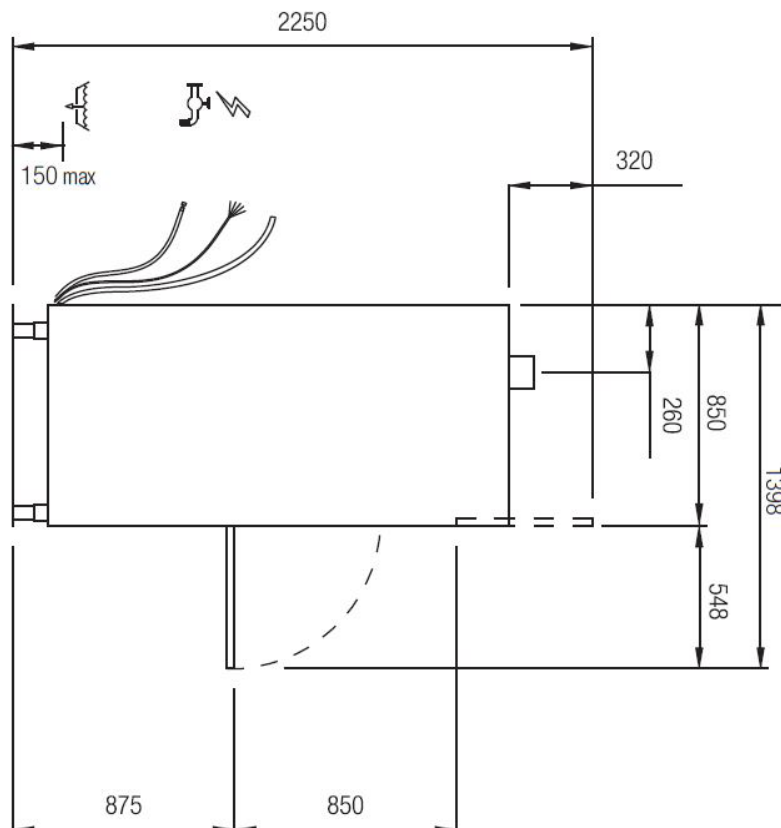
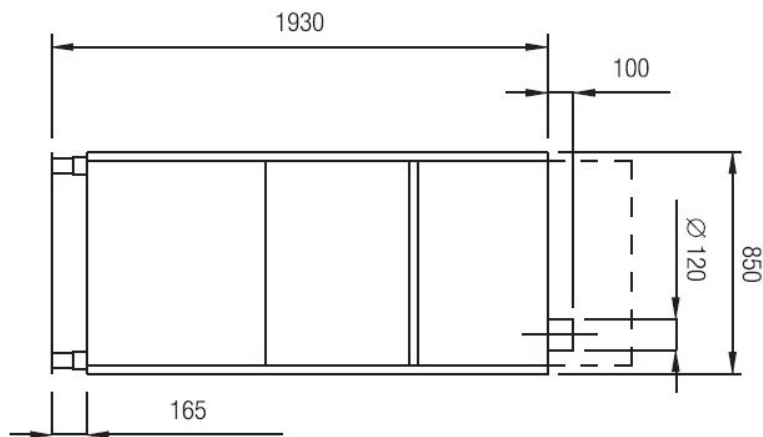

# Technical data sheet

## Product benefits



### Pot and pan washer double skin 70x70 - 400 V

Model

SAP Code

00011972

1

#### Stainless steel outer shell construction

round construction with stainless steel, rounded edges, Deep-drawn bathtub

- easy cleaning, high hygiene standard, long service life

2

#### Stainless steel washing arms

upper and lower arms with stainless steel, separated for washing and rinsing, triple upper arm

- easy and safe handling during cleaning; higher user comfort

3

#### LED Display

smartScreen, a large color graphic display showing the washing progress

- easy control of the dishwasher operation
- continuous information on the status of the wash cycle
- diagnostics in the event of a fault

4

#### Double pump

unique two-way DuoFlow pump

- distributes the water pressure evenly between the upper and lower arms; no noise; allows the use of a weaker pump

5

#### Detergent dispensers

two detergent and rinse aid dispensers

- precise chemical dosing by ProDose - precise dosing system for detergent and rinse aid by peristaltic pump setting of values via control panel

6

#### Double filter system

the chamber filter and the waste filter together with the ArchiMedes system provide a discharge system with increased water purification efficiency

- higher washing efficiency; longer life of the washing bath

7

#### Energy saving

energy saving energy saving system due to lowering the temperature of the boiler

- cost saving

8

#### Protection of fragile dishes

softstart system for gradual start of washing programs to protect fragile dishes

- protects stemmed glasses and other fragile utensils

9

#### Double shell construction

stainless steel construction with insulated double jacket

- quiet operation
- energy saving

10

#### Fast heating

performance management allows the current running of the boiler and basins body

- quick first warm-up of the dishwasher
- smooth operation

11

#### Air break tank

the open system of the boiler rinse, in cooperation with the rinse pump, ensures a constant pressure and temperature of the rinse

- possibility to use in HACCP systems water temperature suitable for sterilization

# Technical data sheet

Technical parameters



## Pot and pan washer double skin 70x70 - 400 V

**Model**

**SAP Code**

00011972

**1. SAP Code:**

00011972

**2. Net Width [mm]:**

857

**3. Net Depth [mm]:**

853

**4. Net Height [mm]:**

1959

**5. Net Weight [kg]:**

181.00

**6. Gross Width [mm]:**

100

**7. Gross depth [mm]:**

950

**8. Gross Height [mm]:**

2200

**9. Gross Weight [kg]:**

191.00

**10. Device type:**

Electric unit

**11. Control type:**

Digital

**12. Material:**

AISI 304

**13. Power electric [kW]:**

18.700

**14. Loading:**

400 V / 3N - 50 Hz

**15. Number of programs:**

8

**16. Opening of device:**

Tilting down

**17. Door clear height [mm]:**

850

**18. Inlet pressure:**

1-6bar

**19. Adjustable feet:**

Yes

**20. Number of skin:**

2

**21. Self-cleaning cycle:**

Yes

**22. Boiler capacity [ l ]:**

12.00

**23. Boiler power [kW]:**

8.000

**24. Basin volume [l]:**

68

**25. Tank power [kW]:**

8.000

**26. Number of arms for both rinsing and washing:**

2

**27. Arm connection:**

Hand loosen/tighten screw

**28. Washing arm type:**

Rotating trident

# Technical data sheet

## Technical parameters



### Pot and pan washer double skin 70x70 - 400 V

Model

SAP Code

00011972

#### 29. Washing arm material:

Stainless steel

#### 30. Atmospheric boiler with rinse pump:

Yes

#### 31. Rinsing arm type:

Rotating trident

#### 32. Rinsing arm material:

Stainless steel

#### 33. Deep drawn tank:

Yes

#### 34. Rack support:

Pressed

#### 35. Tank surface strainers:

stainless steel

#### 36. Drain filter:

ArchiMedes - double filtration with overflow discharge ensures only 18% loss of clean water to waste

#### 37. Thermostop:

Yes

#### 38. Boiler thermostat adjust:

Yes

#### 39. Detergent and rinse pump system:

ProDose - accurate dosing with a peristaltic pump

#### 40. Energy Saving system:

EnergySaving - Energy saving system due to lowering the boiler temperature

#### 41. Rinse system:

UltraRinse2 - stainless steel rinsing arms including stainless steel nozzles with a geometry for spraying water in thin jets directly against the dishes, the rinsing pump ensures constant pressure

#### 42. Heating system:

HotWash - System of simultaneous operation of the heating element of the bath and the boiler, reducing the time for starting the next cycle

#### 43. Quick heating system:

QuickReady - System for rapid heating of water in the tank

#### 44. Hot water electric valve:

Yes

#### 45. Closing door system:

ProSoft - Reduces noise, dampens the door stop, which could cause damage to dishes

#### 46. Rack size [mm]:

700 x 700

#### 47. Display type:

LCD multifunction display

#### 48. USB port:

Yes, for Firmware actualisation

#### 49. Self-diagnostics:

Yes

#### 50. Wash pump type:

two-way - DuoFlow

# Technical data sheet

Technical parameters



## Pot and pan washer double skin 70x70 - 400 V

**Model**

**SAP Code**

00011972

**51. Detergent dispenser:**

Yes

**52. Rinse aid dispenser:**

Yes

**53. Water consumption of the washing cycle:**

4

**54. Washing cycle time [s]:**

120-240-360-720 sec.

**55. Rinse water temperature [°C]:**

80-85

**56. Additional information:**

The product comes with 1x RM Clean+ 12 kg (00012271) and 1x RM Rinse+ 10 kg (00012273) for free

**57. Program ProFessional 2:**

Yes

**58. Program ProFessional 4:**

Yes

**59. Program ProFessional 6:**

Yes

**60. Program ProFessional 8:**

Yes

**61. Program ProFessional 10:**

Yes

**62. Program ProSelf:**

Yes

**63. Program ProEco:**

Yes

**64. Program ProLong:**

Yes